

LEECHIU
PROPERTY CONSULTANTS

PROPERTY FOR LEASE

ASIAN STAR BUILDING

Asean Drive,
Filinvest City, Alabang
Muntinlupa City



ASIAN STAR BUILDING

GENERAL INFORMATION

Developer	Asian Appraisal Holdings, Inc.
Completion Date	1999
Gross Leasable Area	23,500 square meters
Typical Floor Plate	885 square meters
Efficiency	85%
Number of Floors	21
Office Floors	3F to 21F
Certifications	PEZA Certified
Parking Levels	6 floors (B1 - B3, GF - 3F)
Air-Conditioning	Centralized Chilled Water System
Backup Power	100%
Elevators	6 Passenger Lifts 1 Service Lift 2 Parking Lifts
Telco Provider	Bayantel, Globe, PLDT
Ceiling Height	2.6 meters
Handover Condition	Fitted

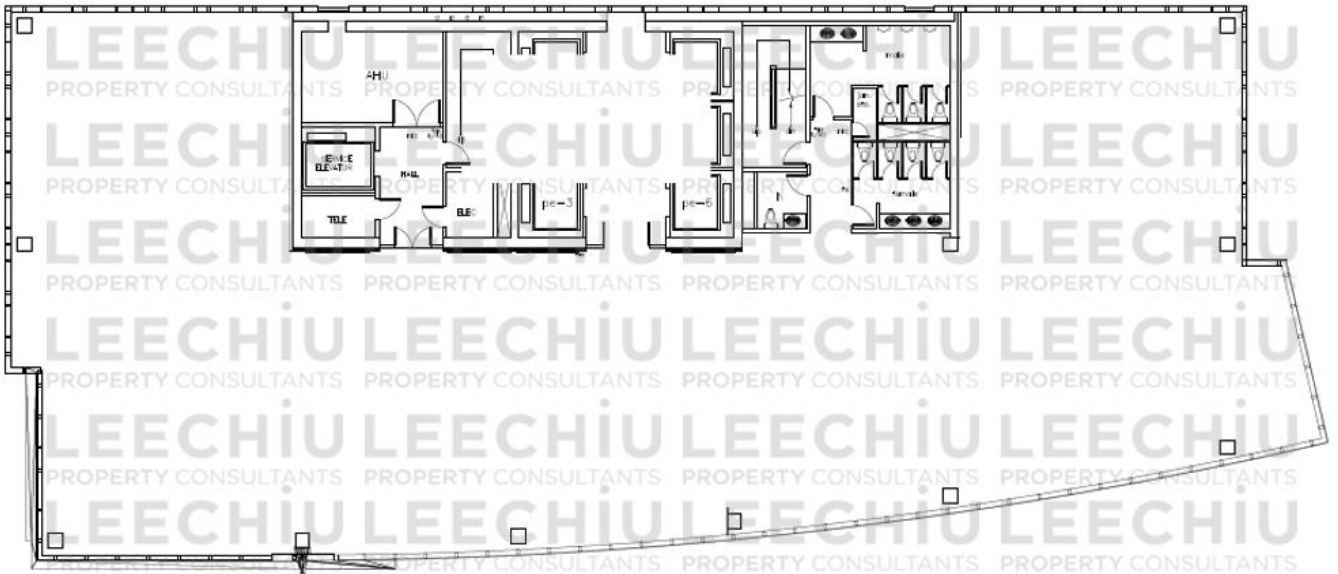

The material and information contained herein are intended only as a guide in helping the recipient hereof to make a decision on whether or not to enter into the appropriate transaction with respect to the Property described herein. The recipient hereof is expected to conduct its own review and assessment of the Property and its suitability for the recipient's intended purpose, including consultation with financial and legal advisers and counsel, for a thorough understanding of all considerations which may be relevant to the recipient's decision to enter into a transaction with respect to the Property described herein. Nothing contained herein may be taken as a representation, warranty, or offer on the part of the Property owner or its representative upon which a binding agreement with respect to the Property may be based. No representation or warranty is made with respect to the accuracy, completeness, or relevance of the material and information contained herein, and Leechiu Property Consultants, Inc., its stockholders, directors, officers, employees, representatives, and agents assume no liability arising from or in relation to the use or reliance of or by any person on the material and information contained herein.