

LEECHIU
PROPERTY CONSULTANTS

PROPERTY FOR LEASE

**TWENTY-FIVE
SEVEN
MCKINLEY**

25TH Street corner
Seventh Avenue,
Bonifacio Global City

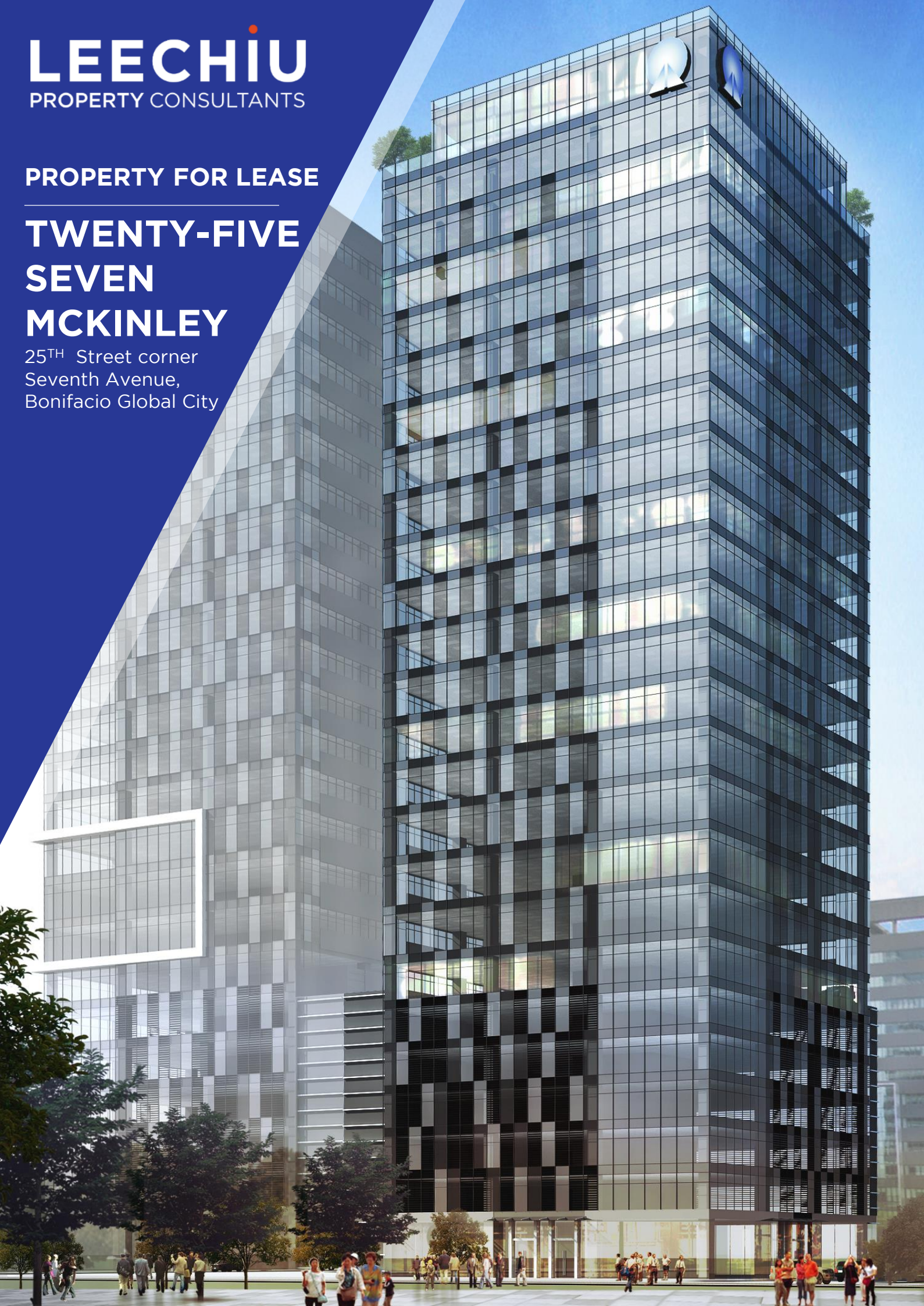

TWENTY-FIVE SEVEN MCKINLEY

GENERAL INFORMATION

Developer	Focus Palantir Inc.
Completion Date	3Q 2018
Gross Leasable Area	19,200 square meters
Typical Floor Plate	1,191.11 square meters
Efficiency	85%
Number of Floors	24 (8F - 24F)
Office Floors	8F to 24F
Certifications	PEZA Certified
Floor Density Ratio	1:6.5
Parking Levels	8 floors (B1 - B2, 2F - 7F)
Air-Conditioning	Variable Refrigerant Flow (VRF)
Backup Power	100%
Elevators	5 Passenger Lifts 1 Service Lift
Ceiling Height	2.8 meters
Handover Condition	Warm Shell

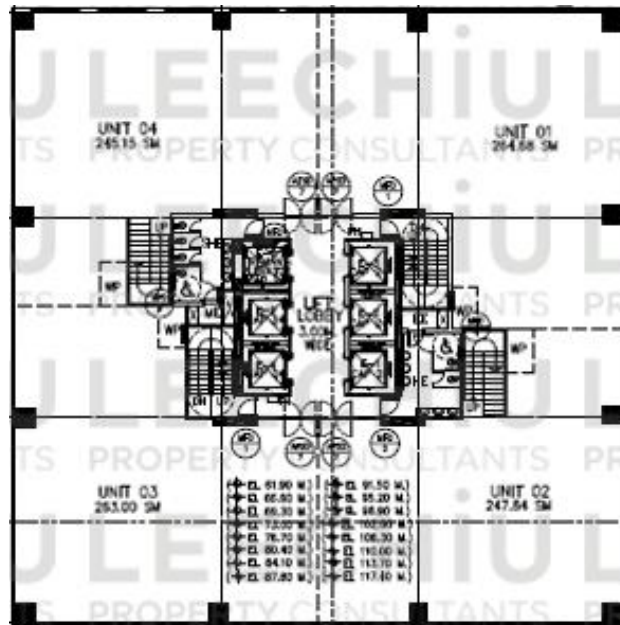
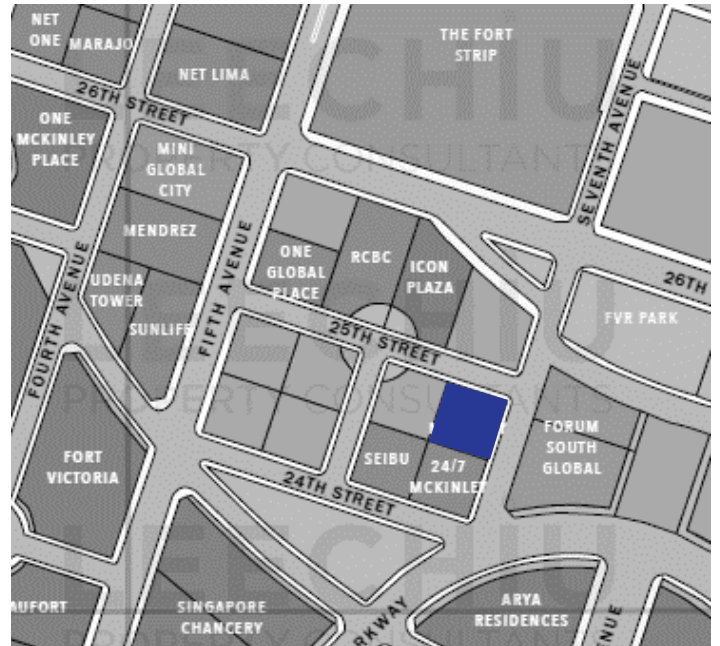

The material and information contained herein are intended only as a guide in helping the recipient hereof to make a decision on whether or not to enter into the appropriate transaction with respect to the Property described herein. The recipient hereof is expected to conduct its own review and assessment of the Property and its suitability for the recipient's intended purpose, including consultation with financial and legal advisers and counsel, for a thorough understanding of all considerations which may be relevant to the recipient's decision to enter into a transaction with respect to the Property described herein. Nothing contained herein may be taken as a representation, warranty, or offer on the part of the Property owner or its representative upon which a binding agreement with respect to the Property may be based. No representation or warranty is made with respect to the accuracy, completeness, or relevance of the material and information contained herein, and Leechiu Property Consultants, Inc., its stockholders, directors, officers, employees, representatives, and agents assume no liability arising from or in relation to the use or reliance of or by any person on the material and information contained herein.