

LEECHIU
PROPERTY CONSULTANTS

PROPERTY FOR LEASE

**MJ CORPORATE
PLAZA**

Chino Roces Avenue
Extension, Makati City



MJ CORPORATE PLAZA

TECHNICAL INFORMATION

Developer	Majalco Inc.
Completion Date	May 2016
Gross Leasable Area	21,295 square meters
Typical Floor Plate	2,549 square meters
Efficiency	Approx. 85%
No. of Floors	12
Certifications	PEZA Accredited
Parking Levels	6 floors (GF, Mezzanine, 3 rd to 6 th)
Floor Density Ratio	1:6
Air-conditioning	Variable Refrigerant Flow (VRF)
Back-up Power	100%
Elevators	6
Telco Provider	PLDT, Globe, Eastern
Ceiling Height	3 meters
Handover Condition	Warm Shell

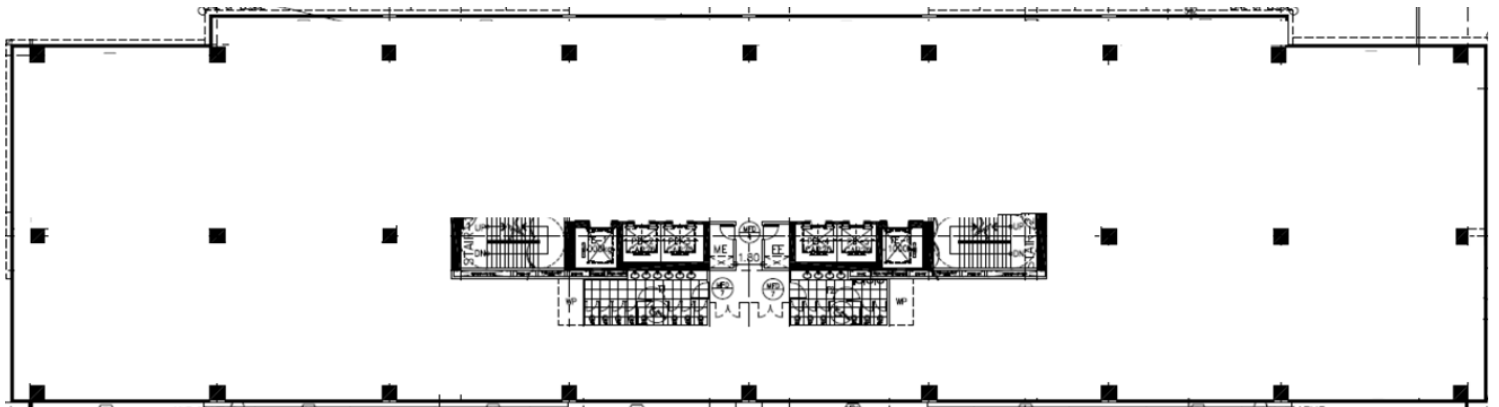

The material and information contained herein are intended only as a guide in helping the recipient hereof to make a decision on whether or not to enter into the appropriate transaction with respect to the Property described herein. The recipient hereof is expected to conduct its own review and assessment of the Property and its suitability for the recipient's intended purpose, including consultation with financial and legal advisers and counsel, for a thorough understanding of all considerations which may be relevant to the recipient's decision to enter into a transaction with respect to the Property described herein. Nothing contained herein may be taken as a representation, warranty, or offer on the part of the Property owner or its representative upon which a binding agreement with respect to the Property may be based. No representation or warranty is made with respect to the accuracy, completeness, or relevance of the material and information contained herein, and Leechiu Property Consultants, Inc., its stockholders, directors, officers, employees, representatives, and agents assume no liability arising from or in relation to the use or reliance of or by any person on the material and information contained herein.