

PROPERTY FOR LEASE

NEXGEN TOWER

EDSA Extension
Pasay City



NEXGEN TOWER

GENERAL INFORMATION

Developer	Millenium Properties and Brokerage Inc.
Completion Date	4Q 2017
Building Grade	A
Gross Leasable Area	19,756 square meters
Typical Floor Plate	2,356.52 square meters
Net Usable Area	2,061.76 square meters
Efficiency	88%
Number of Floors	11
Office Floors	4F - 11F
Certifications	Under Application for PEZA
Floor Density Ratio	1:5
Parking Levels	2 floors (Podium)
Air-Conditioning	Variable Refrigerant Flow
Backup Power	100%
Elevators	7 Passenger 1 Service
Telco Provider	Globe, PLDT
Ceiling Height	2.7 meters
Handover Condition	Warm Shell

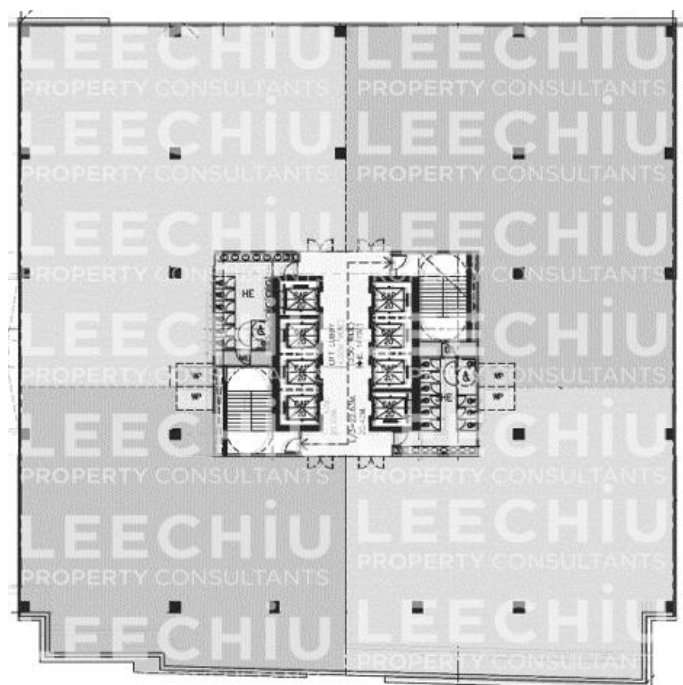
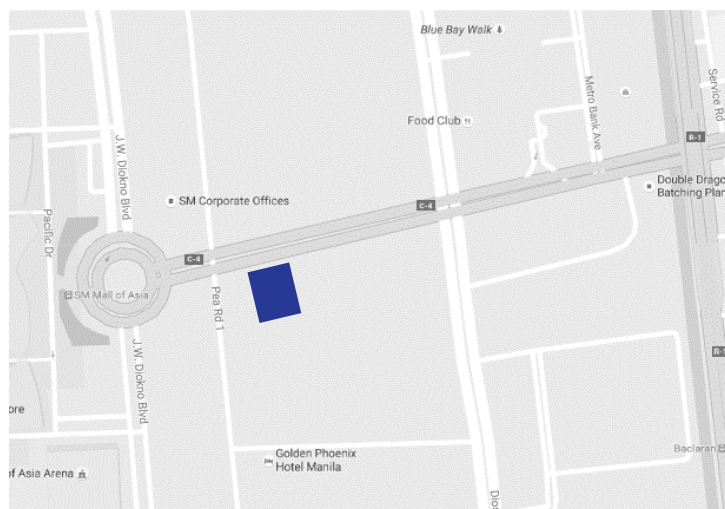

The material and information contained herein are intended only as a guide in helping the recipient hereof to make a decision on whether or not to enter into the appropriate transaction with respect to the Property described herein. The recipient hereof is expected to conduct its own review and assessment of the Property and its suitability for the recipient's intended purpose, including consultation with financial and legal advisers and counsel, for a thorough understanding of all considerations which may be relevant to the recipient's decision to enter into a transaction with respect to the Property described herein. Nothing contained herein may be taken as a representation, warranty, or offer on the part of the Property owner or its representative upon which a binding agreement with respect to the Property may be based. No representation or warranty is made with respect to the accuracy, completeness, or relevance of the material and information contained herein, and Leechiu Property Consultants, Inc., its stockholders, directors, officers, employees, representatives, and agents assume no liability arising from or in relation to the use or reliance of or by any person on the material and information contained herein.

LEECHIU
PROPERTY CONSULTANTS

www.leechiu.com

**EXCLUSIVE
AGENT**

PHILLIP ANONUEVO

☎ 0917.538.0115

✉ phillip.anonuevo@leechiu.com

JOY LOPEZ

☎ 0917.832.5949

✉ joy.lopez@leechiu.com

MIGUEL MANIPOL

☎ 0917.898.8830

✉ miguel.manipol@leechiu.com

TOMAS JOAQUIN

☎ 0917.120.2426

✉ tomas.reyes@leechiu.com