

PROPERTY FOR LEASE

PANORAMA TECHNO CENTER

EDSA, Quezon City



PANORAMA TECHNOCENTER

GENERAL INFORMATION

Developer	Panorama Development Corporation
Completion Date	1Q 2017
Building Grade	A
Gross Leasable Area	32,857.55 square meters
Typical Floor Plate	2,467.35 square meters
Net Usable Area	2,072.57 square meters
Efficiency	84%
Number of Floors	18
Office Floors	Half of 6F - 18F
Certifications	PEZA Certified
Floor Density Ratio	1:5.9
Parking Levels	4 floors (3F - 6F)
Air-Conditioning	Variable Refrigerant Flow
Backup Power	100%
Elevators	9 Passenger 1 Service 4 Parking
Telco Provider	Globe, PLDT
Ceiling Height	3 meters
Handover Condition	Warm Shell

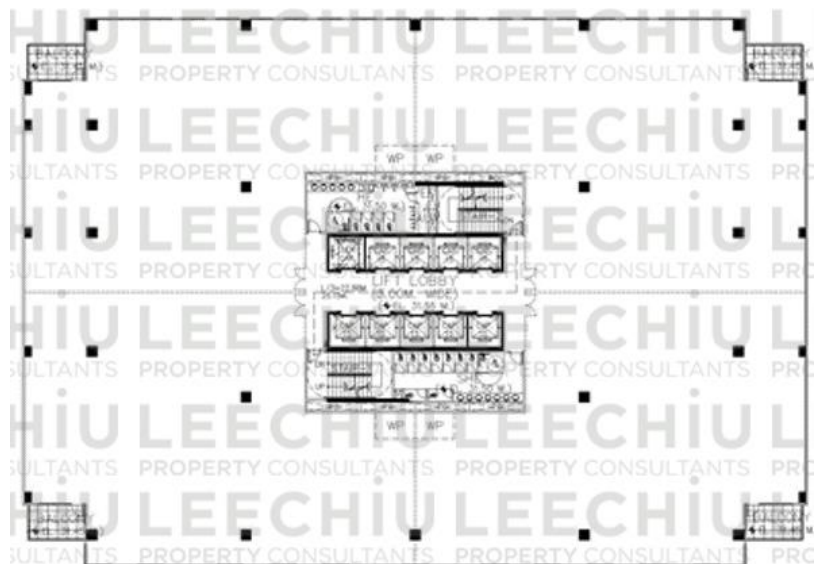
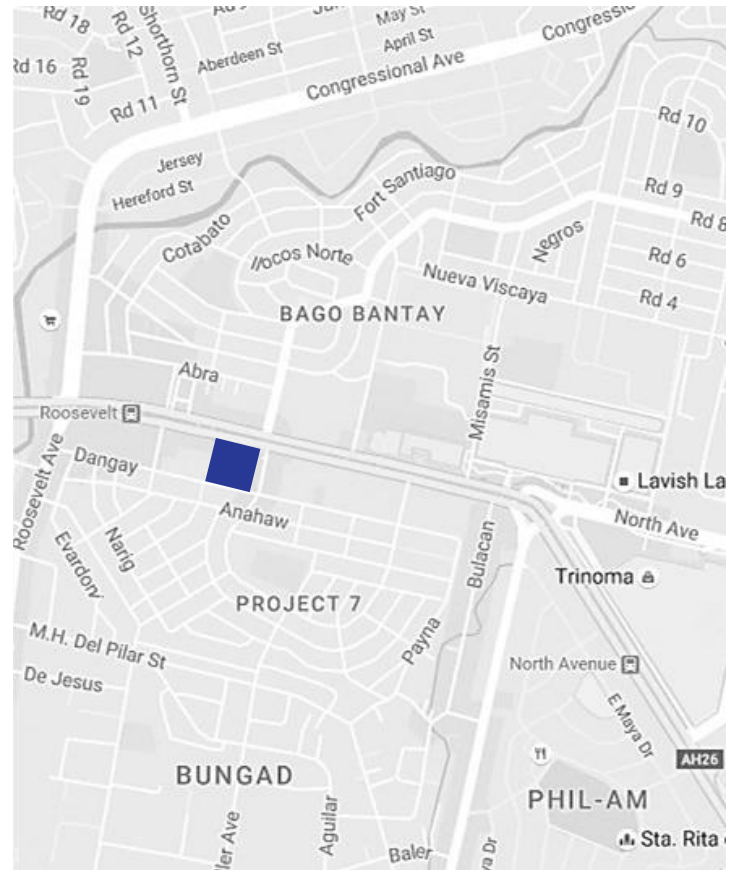

The material and information contained herein are intended only as a guide in helping the recipient hereof to make a decision on whether or not to enter into the appropriate transaction with respect to the Property described herein. The recipient hereof is expected to conduct its own review and assessment of the Property and its suitability for the recipient's intended purpose, including consultation with financial and legal advisers and counsel, for a thorough understanding of all considerations which may be relevant to the recipient's decision to enter into a transaction with respect to the Property described herein. Nothing contained herein may be taken as a representation, warranty, or offer on the part of the Property owner or its representative upon which a binding agreement with respect to the Property may be based. No representation or warranty is made with respect to the accuracy, completeness, or relevance of the material and information contained herein, and Leechiu Property Consultants, Inc., its stockholders, directors, officers, employees, representatives, and agents assume no liability arising from or in relation to the use or reliance of or by any person on the material and information contained herein.