

OFFICE SPACE FOR LEASE

JOLLIBEE TOWER

F. Ortigas Jr. corner
Garnet Road, Ortigas
CBD, Pasig City



JOLLIBEE TOWER

GENERAL INFORMATION

Developer	DoubleDragon Properties Corporation
Completion Date	4Q 2019
Building Grade	A
Certifications	Under PEZA accreditation LEED Silver
No. of Floors	41
Gross Leasable Area	60,040 sqm
Typical Floor Plate	Approx. 1,768.86 sqm
Backup Power	100%
Aircon System	VRF
Ceiling Height	3 meters

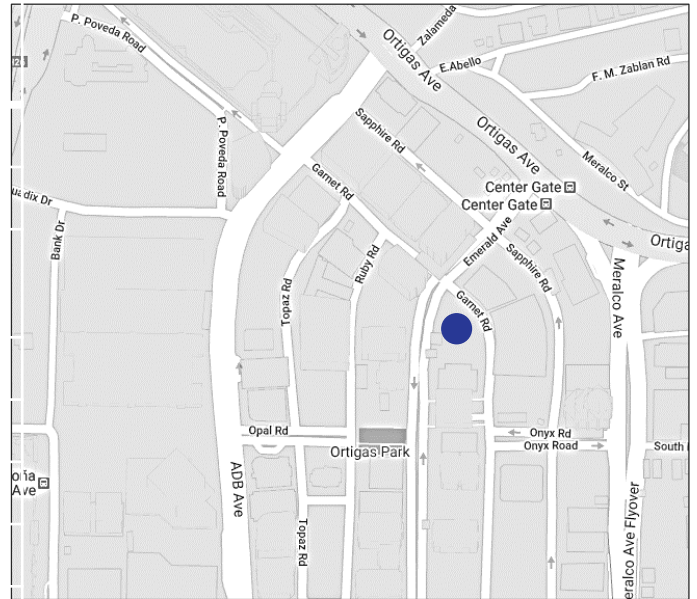

TYPICAL FLOOR PLAN

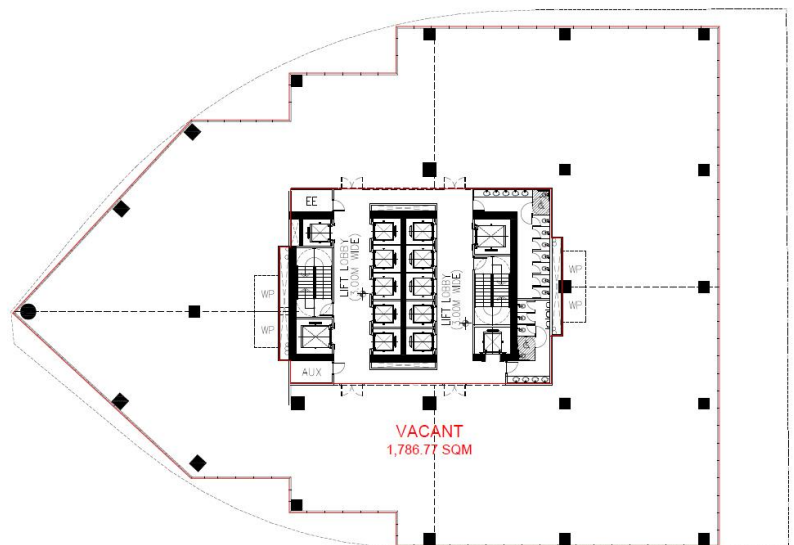

The material and information contained herein are intended only as a guide in helping the recipient hereof to make a decision on whether or not to enter into the appropriate transaction with respect to the Property described herein. The recipient hereof is expected to conduct its own review and assessment of the Property and its suitability for the recipient's intended purpose, including consultation with financial and legal advisers and counsel, for a thorough understanding of all considerations which may be relevant to the recipient's decision to enter into a transaction with respect to the Property described herein. Nothing contained herein may be taken as a representation, warranty, or offer on the part of the Property owner or its representative upon which a binding agreement with respect to the Property may be based. No representation or warranty is made with respect to the accuracy, completeness, or relevance of the material and information contained herein, and Leechiu Property Consultants, Inc., its stockholders, directors, officers, employees, representatives, and agents assume no liability arising from or in relation to the use or reliance of or by any person on the material and information contained herein.