

Prime Corner Property Ideal for Commercial and Residential Development



[GOOGLE MAPS LINK](#)

PROPERTY DETAILS

- Address** **Quirino Highway
corner Sarmiento Street
Novaliches Bayan, Quezon City**
- Lot Area** 3,155 Square Meters
- Total Price** *Please contact Agent*
- Zoning and other information**
 - Commercial 3 (C-3)
C-3 District is characterized by heavy commercial developments and multi-level commercial structures, as well as high-density residential developments.
 - With rental income
 - Vacant possession by July 2025

LOT PLAN

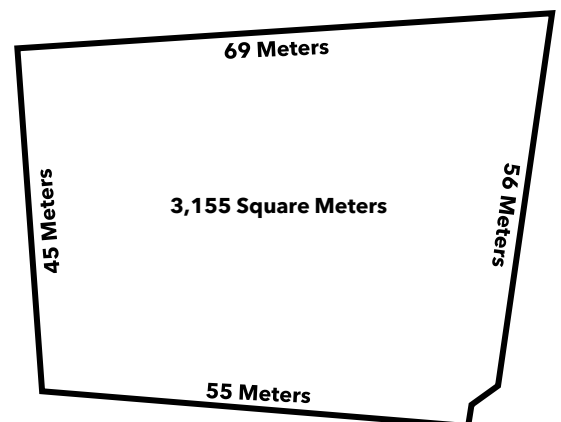

GET IN TOUCH

ALVIN MAGAT

+63917 538 1038

REB Lic.# 29039, ID# 21-47000902 until 07/18/2025
PTR# 9572619 until 12/31/23

TINA CORNEJO

+63917 895 8462

REB Lic.# 7612, ID# 19-3210255 until 11/29/2023
PTR# 9572609 until 12/31/23

PROPERTY FOR SALE

PROPERTY PHOTO



[CLICK HERE FOR DRONE VIDEO](#)

VICINITY MAP

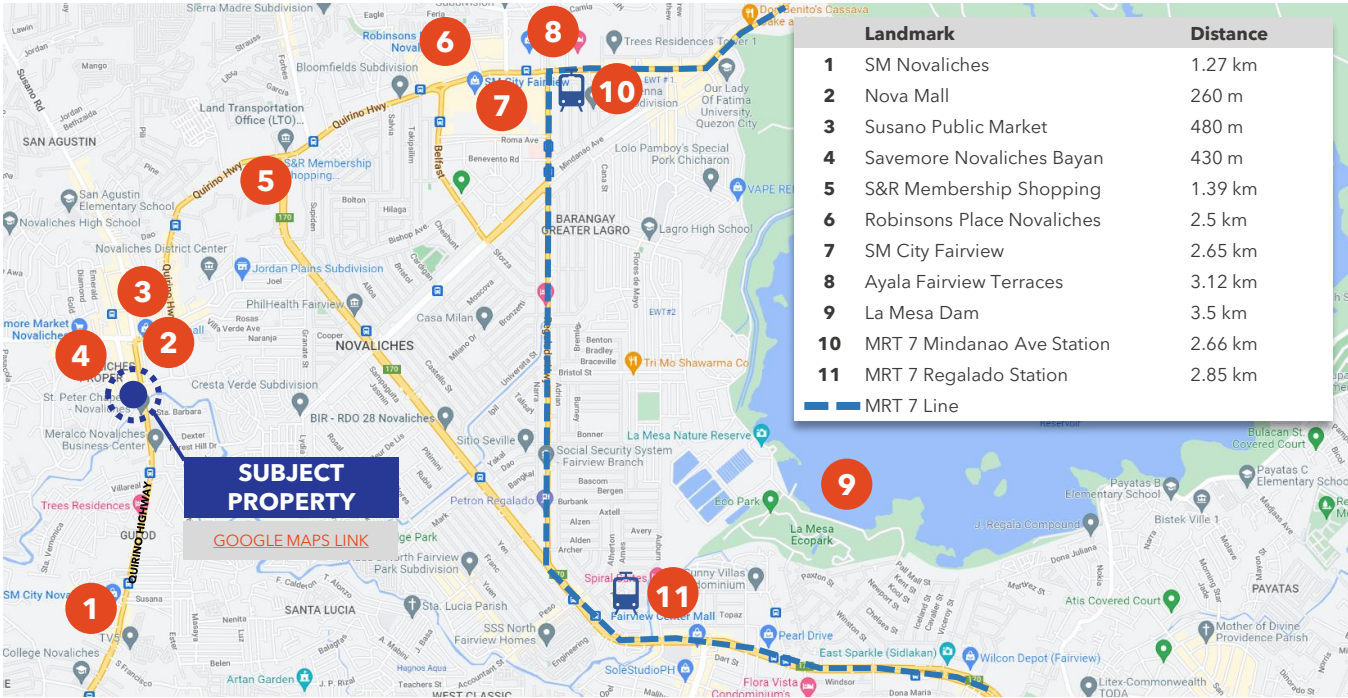

GET IN TOUCH

ALVIN MAGAT

+63917 538 1038

REB Lic.# 29039, ID# 21-47000902 until 07/18/2025
PTR# 9572619 until 12/31/23

TINA CORNEJO

+63917 895 8462

REB Lic.# 7612, ID# 19-3210255 until 11/29/2023
PTR# 9572609 until 12/31/23

DISCLAIMER

This document is prepared by Leechu Property Consultants (LPC) for information only and is based on information and representations provided to LPC. While reasonable care has been exercised in preparing this document, LPC does not warrant the accuracy or completeness of the information contained herein. LPC shall not be responsible for any losses or liability of any nature arising from or in connection with reliance, in whole or in part, on the contents of this document. Except as may otherwise be expressly indicated herein, LPC does not undertake any obligation to advise any recipient hereof of any changes or updates with respect to the information contained herein. Interested parties should not rely on the statements or representations of fact as contained in this document, and are expected to conduct due diligence and independent verification of the information contained herein. Interested parties are encouraged to consult with their legal, financial, and tax advisers in evaluating the transaction described herein, as this document does not purport to be an exhaustive and/or definitive summary of all commercial, legal, and financial matters which may be material to your decision to proceed (or not to proceed) with the proposed transaction. This document does not constitute, in whole or in part, an offer by LPC or contract between LPC and any recipient hereof.